

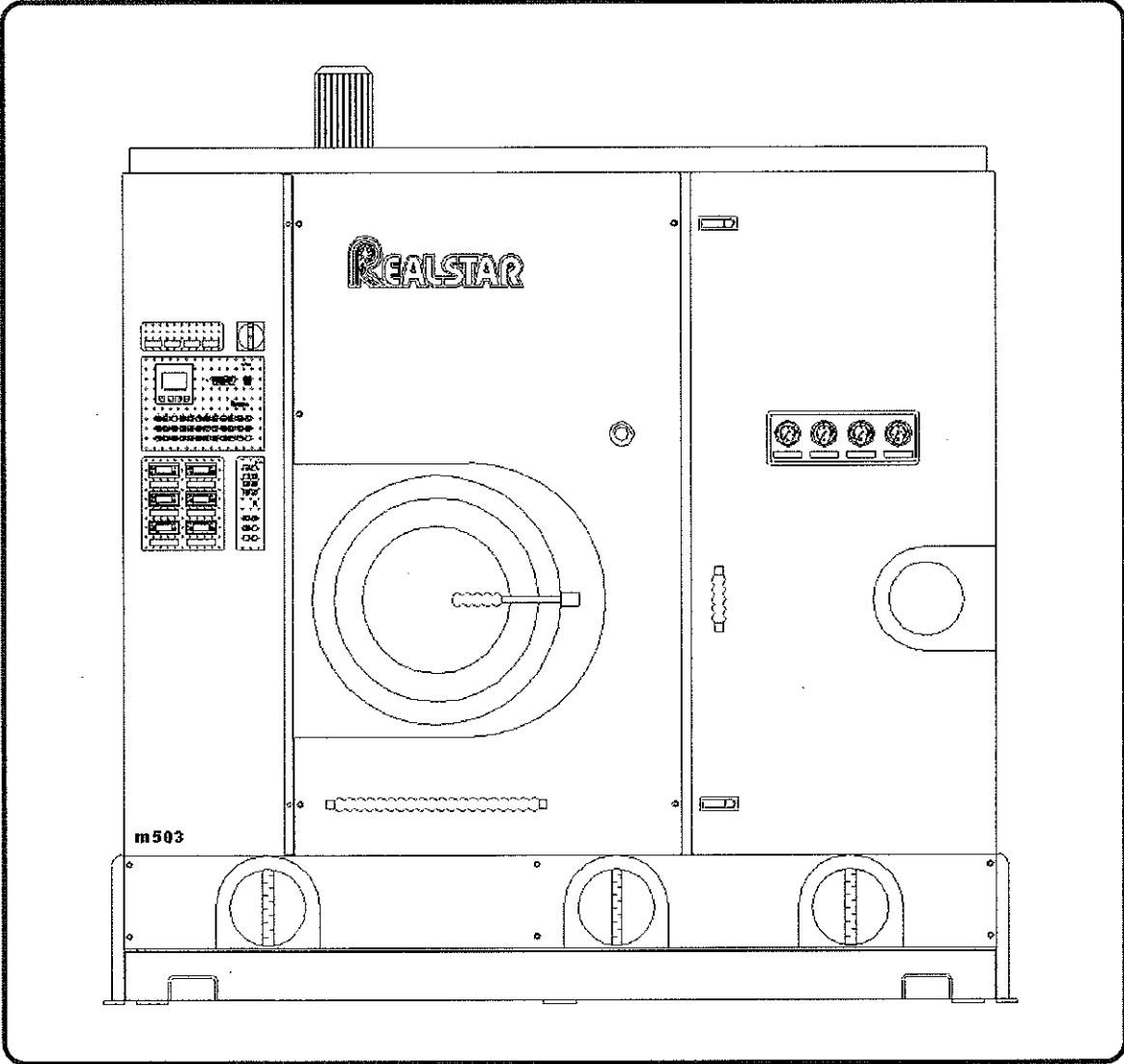

TECHNICAL INFORMATION



M503

SOLVENT TYPE	PERCHLORETHYLENE	
MACHINE CAPACITY (RATIO 1:20)	Lbs	55 ÷ 60

BASKET

Diameter	inches	39.4
Depth	inches	25,2
Volume	Cu-Ft	17,8
Wash Speed	rpm	33
Extract Speed	rpm	190÷380
Door Opening	inches	20

SOLVENT TANKS

Useful Volume Tank 1	gal	42
Useful Volume Tank 2	gal	42
Useful Volume Tank 3	gal	53

FLOOR SAFETY TANK

Floor Safety Tank Capacity	gal	114
----------------------------	------------	------------

DESTILLATOR

Useful Volume at Half Inspection	gal	68
Total Volume	gal	86
Boiler Water Capacity	gal	2.6

ELECTRIC POWER

(220 V - 60 Hz)

Wash Motor	hp	1.5	kW	1.13
Extract Motor	hp	4.5	kW	3.38
Solvent Pump Motor	hp	1.5	kW	1.1
Fan Motor	hp	3	kW	2.2
Refrigerator Compressor Motor	hp	6.5	kW	4.85
Air Compressor Motor	hp	0.5	kW	0.37
Nylon Filter Motor	hp	0.75	kW	0.55
Still Residue Pump Motor	hp	0.75	kW	0.55
Heater Electric Elements	hp		kW	12
Still Electric Elements	hp		kW	13.5
Exhaust Fan Motor	hp	0.18	kW	0.13
Air Clean Blower	hp	1	kW	0.75

NOTE: Acoustic emission level of the machine is lower than 70 dB (A)

FILTRATION AVAILABLE IN THIS MODEL
Version - One Cartridge Filter KR

	KR Cartridge Volume	gal	22.5
	KR Cartridge Area	ft ²	28 x 3 = 84
	KR Cartridge Quantity	nr	3

Version - One Nylon Filter

	Nylon Filter Volume	gal	20
	Nylon Filter Area	ft ²	63
	Filter Disks	nr	39

Version - One Nylon Filter and One Cartridge Filter KR

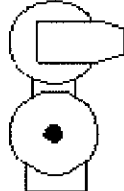
	Nylon Filter Volume	gal	20
	Nylon Filter Area	ft ²	63
	Filter Disks	nr	39
	KR Cartridge Volume	gal	22.5
	KR Cartridge Area	ft ²	28 x 3 = 84
	KR Cartridge Quantity	nr	3

Version - Two Nylon Filters

	Nylon Filter Volume	gal	20 x 2 = 40
	Nylon Filter Area	ft ²	63 x 2 = 126
	Filter Disks	nr	39 x 2 = 78

FILTRATION AVAILABLE IN THIS MODEL
Version - Two Cartridge Filters KR

	KR Cartridge Volume	gal	22.5 x 2 = 45
	KR Cartridge Area	ft ²	28 x 6 = 168
	KR Cartridge Quantity	nr	3 x 2 = 6

Version - One Nylon Filter and One Deco Filter PR

	Nylon Filter Volume	gal	20
	Nylon Filter Area	ft ²	63
	Filter Disks	nr	39
	PR Deco Filter Volume	gal	6.6
	PR Cartridge Quantity	nr	2
	PR Decolorating carbon Quantity	Lbs	8.8

Version - One Nylon Filter-One Cartridge Filter KR-One Deco Filter PR

	Nylon Filter Volume	gal	20
	Nylon Filter Area	ft ²	63
	Filter Disks	nr	39
	KR Cartridge Volume	gal	22.5
	KR Cartridge Area	ft ²	28 x 3 = 84
	KR Cartridge Quantity	nr	3
	PR Deco Filter Volume	gal	6.6
	PR Cartridge Quantity	nr	2
	PR Decolorating carbon Quantity	Lbs	8.8

FILTRATION AVAILABLE IN THIS MODEL
Version - Two Nylon Filters and One Deco Filter PR

	Nylon Filter Volume	gal	20 x 2 = 40
	Nylon Filter Area	ft ²	63 x 2 = 126
	Filter Disks	nr	39 x 2 = 78
	PR Deco Filter Volume	gal	6.6
	PR Cartridge Quantity	nr	2
	PR Decolorating carbon Quantity	Lbs	8.8

Version+ - Two Nylon Filters and Two Deco Filters PR

	Nylon Filter Volume	gal	20 x 2 = 40
	Nylon Filter Area	ft ²	63 x 2 = 126
	Filter Disks	nr	39 x 2 = 78
	PR Deco Filter Volume	gal	6.6 x 2 = 13.2
	PR Cartridge Quantity	nr	2 x 2 = 4
	PR Decolorating carbon Quantity	Lbs	8.8 x 2 = 17.6

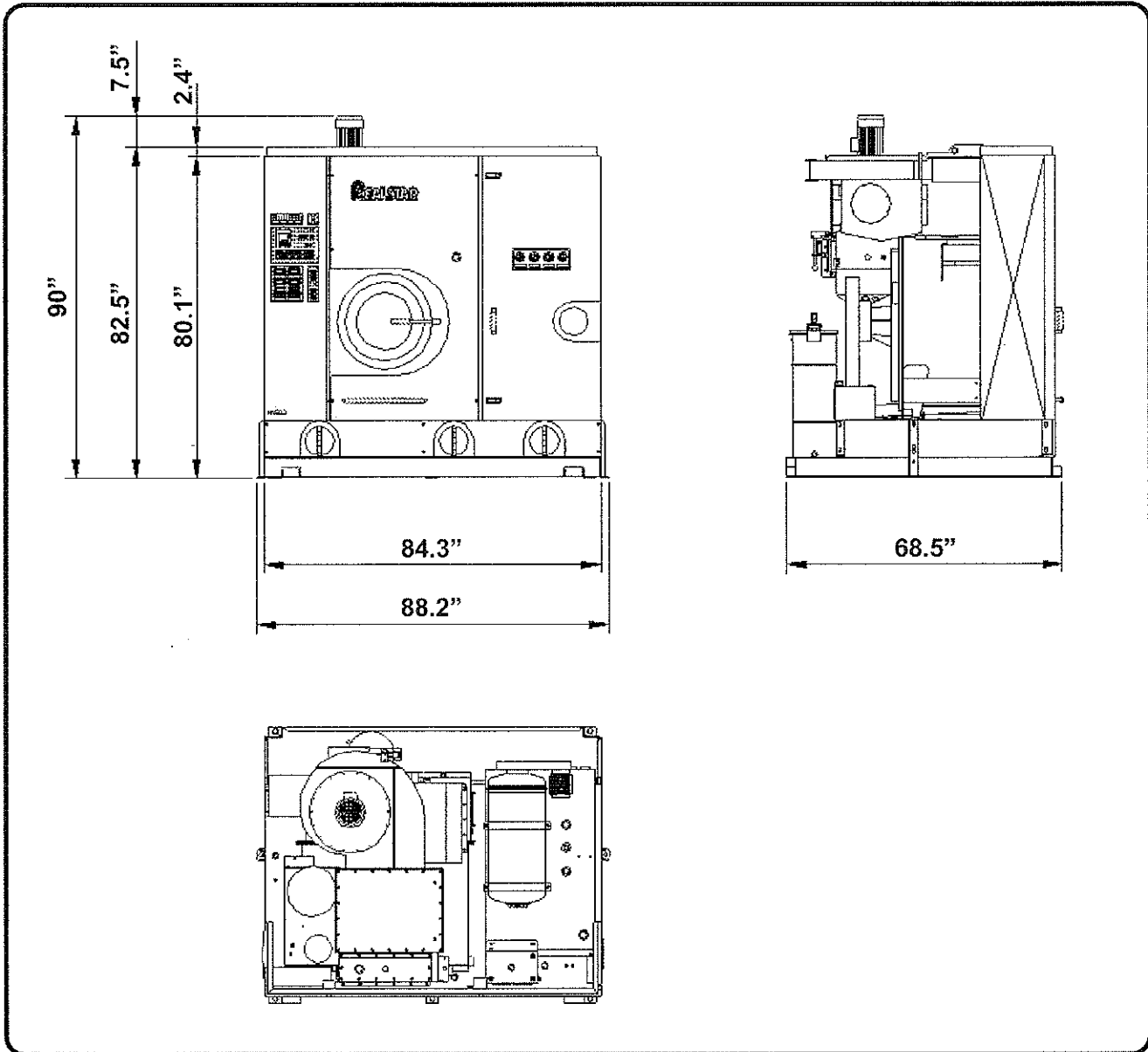
Dimensions and weight - ULTRA Version

CHARGES

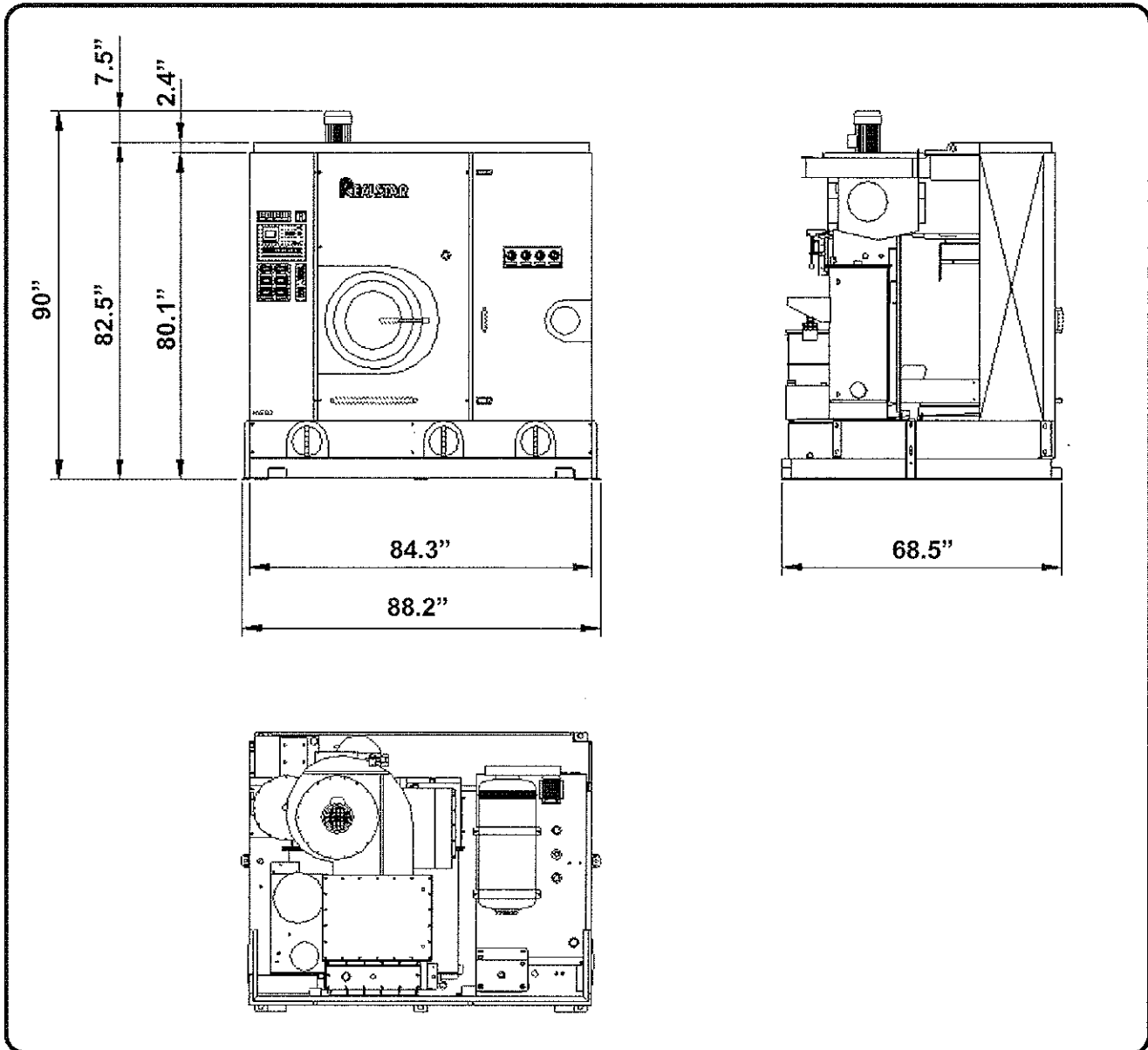
Empty machine weight	Lbs	4520
Machine weight with solvent	Lbs	7060
Static charge on the floor with solvent	Lbs/ft ²	177
Dynamic charge on the floor (+ 10 %)	Lbs/ft ²	232

Dimensions and weight - ULTRA DIAMOND Version

CHARGES

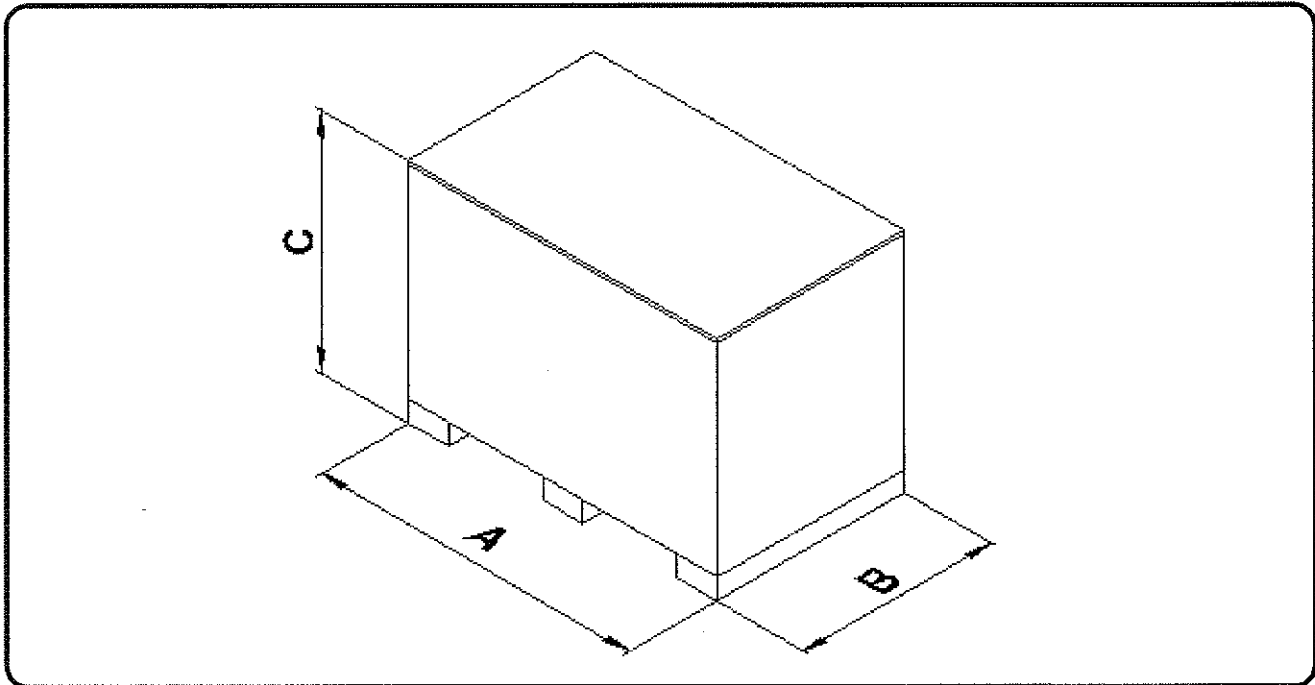
Empty machine weight	Lbs	5180
Machine weight with solvent	Lbs	7720
Static charge on the floor with solvent	Lbs/ft ²	193
Dynamic charge on the floor (+ 10 %)	Lbs/ft ²	250

PACKAGED MACHINE DIMENSIONS AND WEIGHTS



PACKAGED MACHINE DIMENSIONS				
Machine Type		Carton	Wooden cage	Wooden case
M 503 ULTRA	A	88.19 inches	-	-
	B	73.62 inches	-	-
	C	95.67 inches	-	-
M 503 ULTRA DIAMOND	A	88.19 inches	-	-
	B	73.62 inches	-	-
	C	95.67 inches	-	-

PACKAGED MACHINE WEIGHTS			
Machine Type	Carton	Wooden cage	Wooden case
M 503 ULTRA	4785 Lbs	-	-
M 503 ULTRA DIAMOND	5445 Lbs	-	-

FIXING POINTS - WITH SAFETY TANK

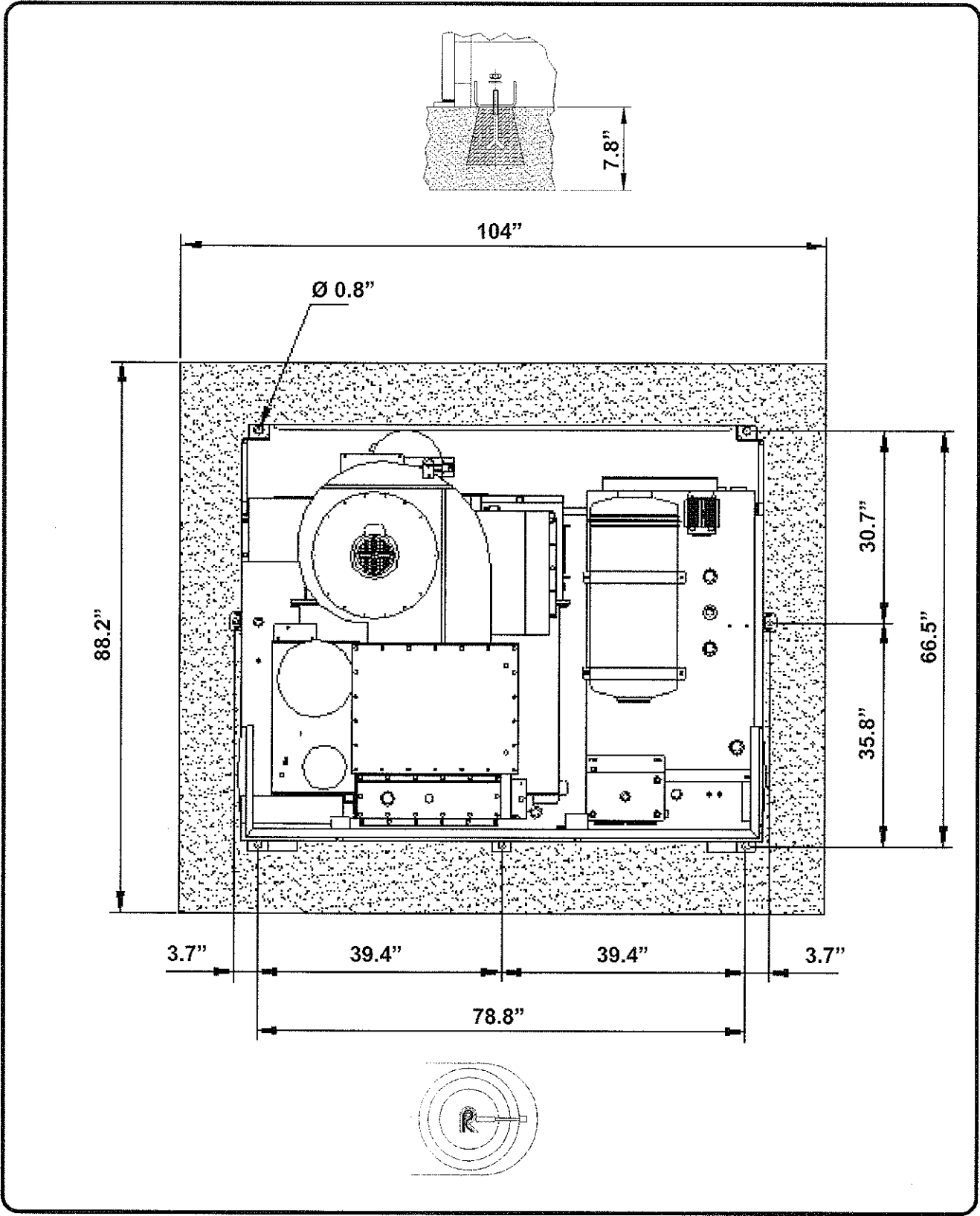

FIXING POINTS - WITHOUT SAFETY TANK

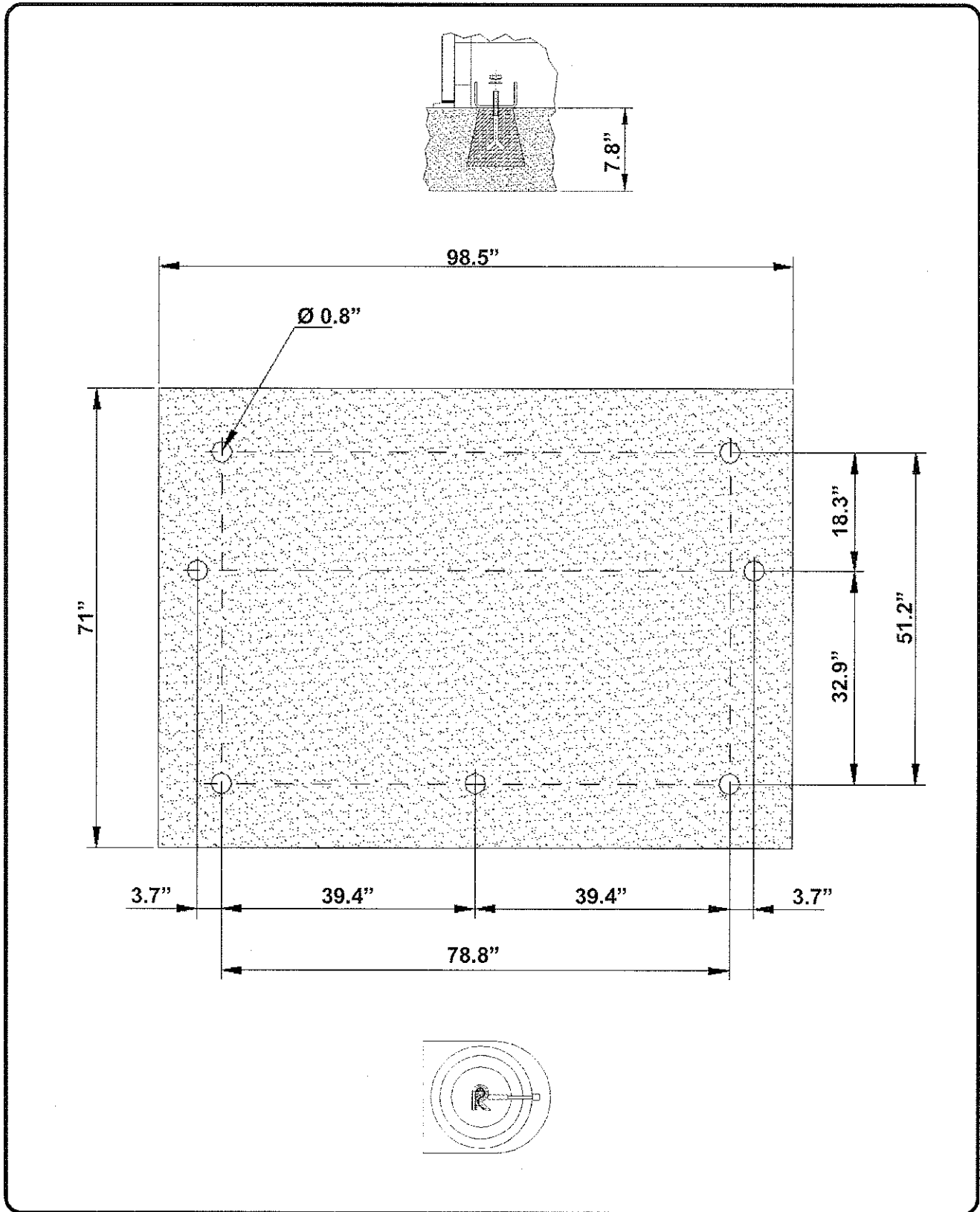

CONNECTIONS

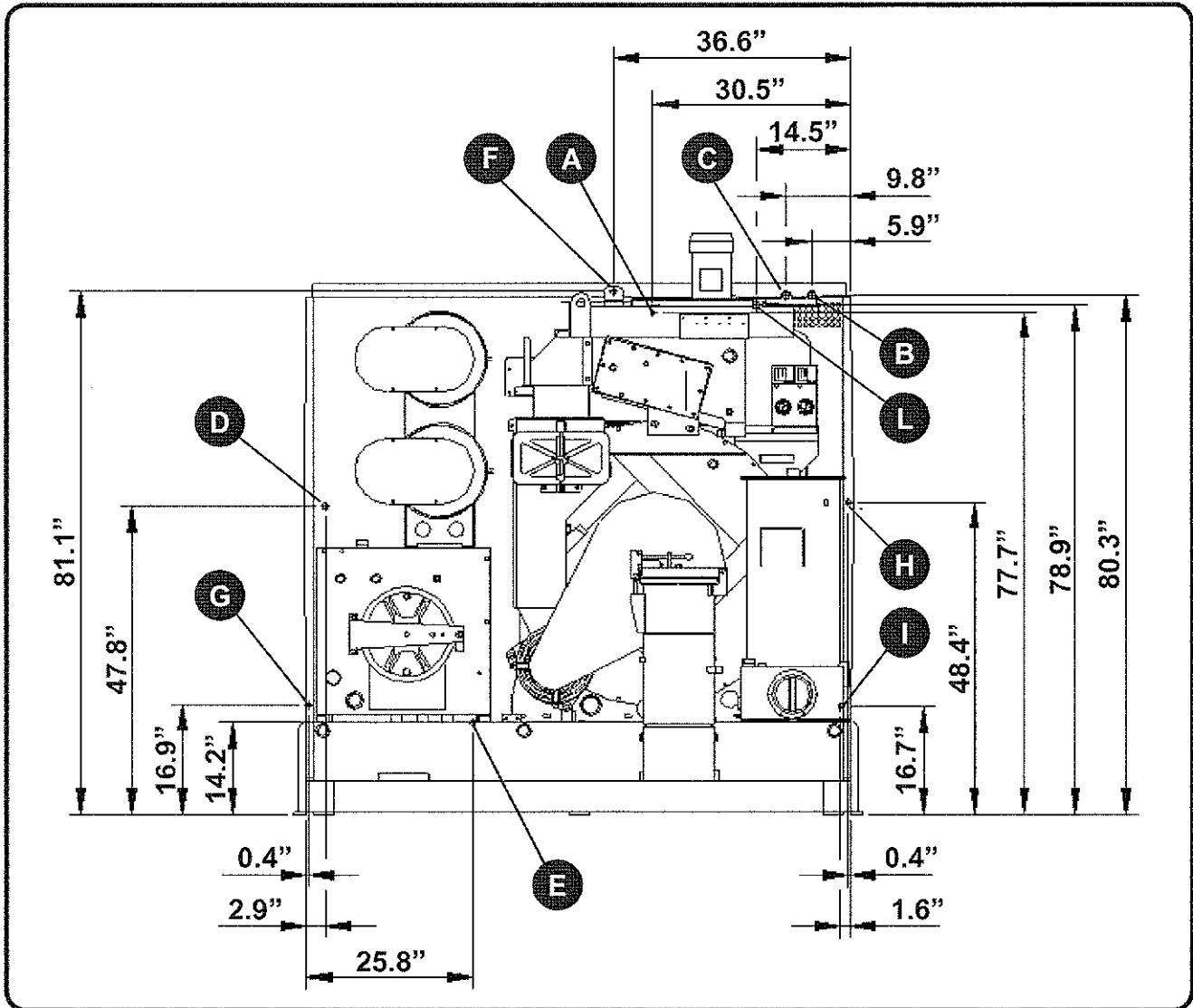

A	Compressed air inlet	mm 4
B	Water inlet	Ø 3/4"
C	Water outlet	Ø 3/4"
D	Steam still inlet	Ø 1/2"
E	Condensate still outlet	Ø 1/2"
F	Steam heater inlet	Ø 1/2"
G	Condensate heater outlet	Ø 1/2"
H	Steam Air Clean inlet	Ø 1/2"
I	Condensate Air Clean outlet	Ø 1/2"
L	Electric connection	

SOLVENT TYPE		PERCHLORETHYLENE		
NECESSARY QUANTITY OF SOLVENT TO FILL THE MACHINE				
Machine Version - 1 Cartridge Filter KR	gal	159	Lbs	2115
Machine Version - 1 Nylon Filter	gal	157	Lbs	2099
Machine Version - 1 Nylon Filter and 1 cartridge filter KR	gal	179	Lbs	2380
Machine Version - 2 Nylon Filters	gal	177	Lbs	2363
Machine Version - 2 Cartridge Filters KR	gal	192	Lbs	2554
Machine Version - 1 Nylon Filter and 1 Deco Filter PR	gal	164	Lbs	2187
Machine Version - 1 Nylon Filter - 1 Filter KR - 1 Deco Filter PR	gal	186	Lbs	2474
Machine Version - 2 Nylon Filters and 1 Deco Filter PR	gal	184	Lbs	2451
Machine Version - 2 Nylon Filters and 2 Deco Filters PR	gal	191	Lbs	2540

INFORMATION FOR THE ELECTRICAL CONNECTIONS		(220 V - 60 Hz)		
ELECTRIC Version with DHP	kW	-	Amp	-
ELECTRIC Version without DHP	kW	-	Amp	-
Dissipated Heat - ELECTRIC Version with DHP	kW/h	-	Kcal	-
Dissipated Heat - ELECTRIC Version without DHP	kW/h	-	Kcal	-
STEAM Version	kW	9.5	Amp	60
Dissipated Heat - STEAM Version	kW/h	1.99	Kcal	1715

GENERAL INFORMATION		
Required water capacity	gal/min	3
Required water pressure	psi	40 ÷ 70
Required water temperature	°F	69° ÷ 70°
Required air pressure	psi	110 ÷ 115
Required steam pressure (Steam Version)	psi	55 ÷ 70
Required steam availability (Steam Version)	Lbs/h	132